

**HANGER SHELF**  
PREPARATION AND INSTALLATION  
INSTRUCTION MANUAL

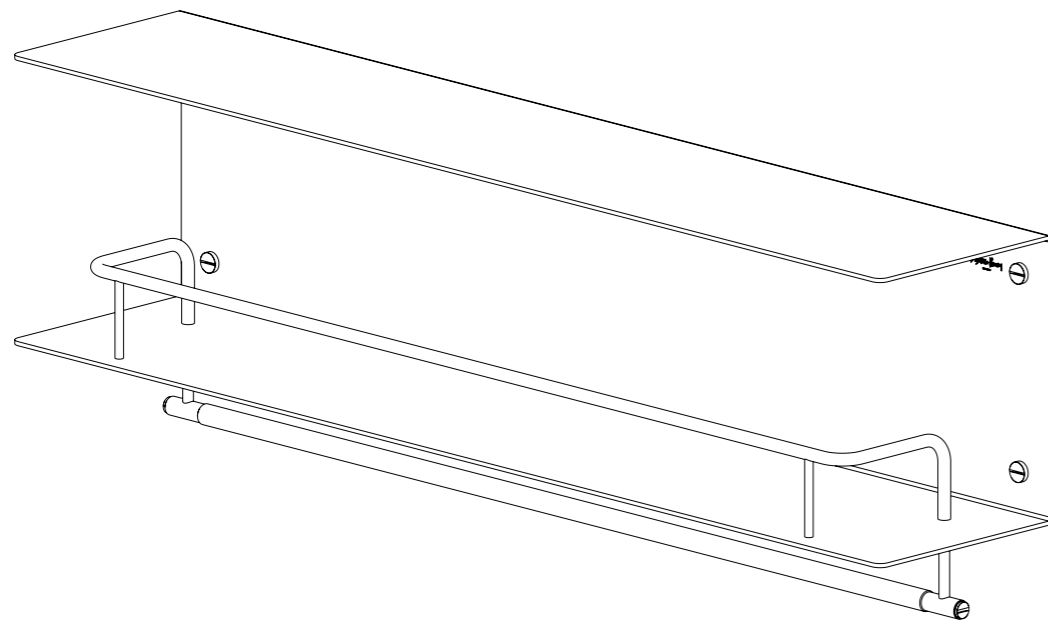

**DETAILS KIT**  
**CONTENTS**

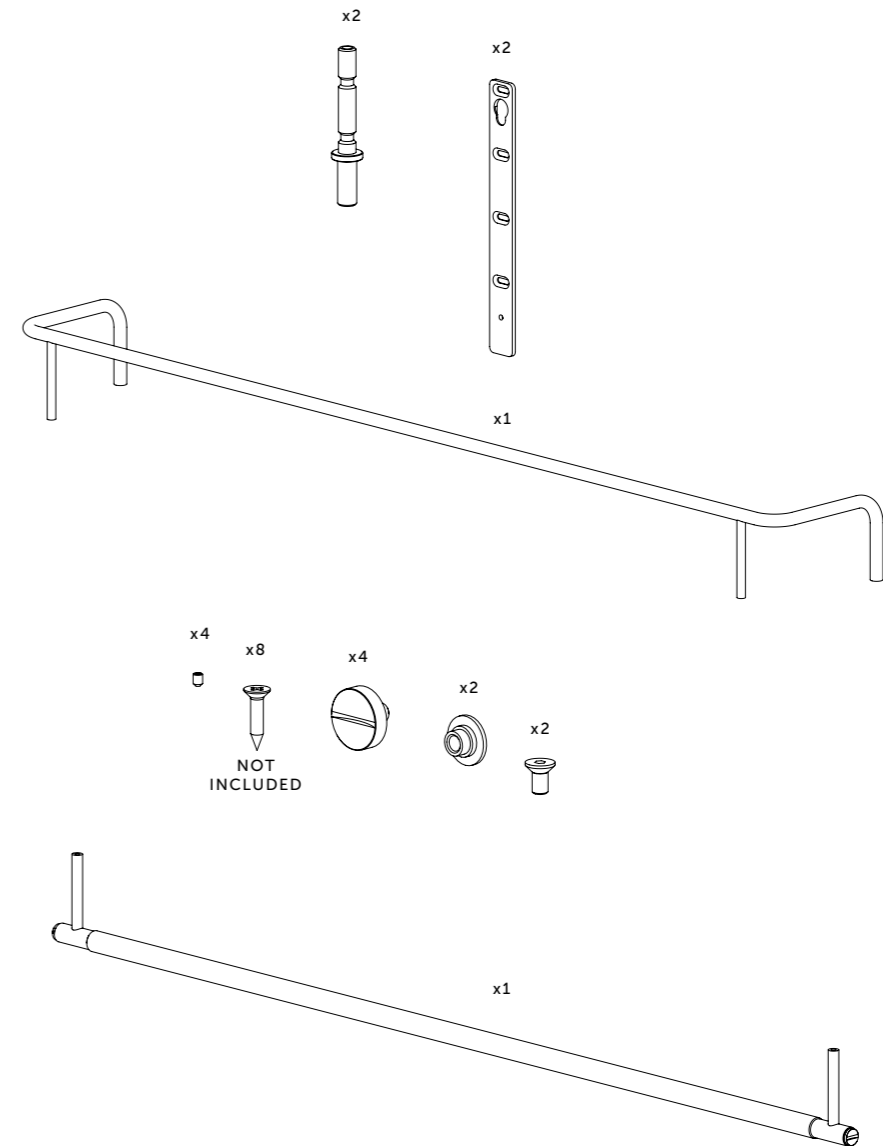

1

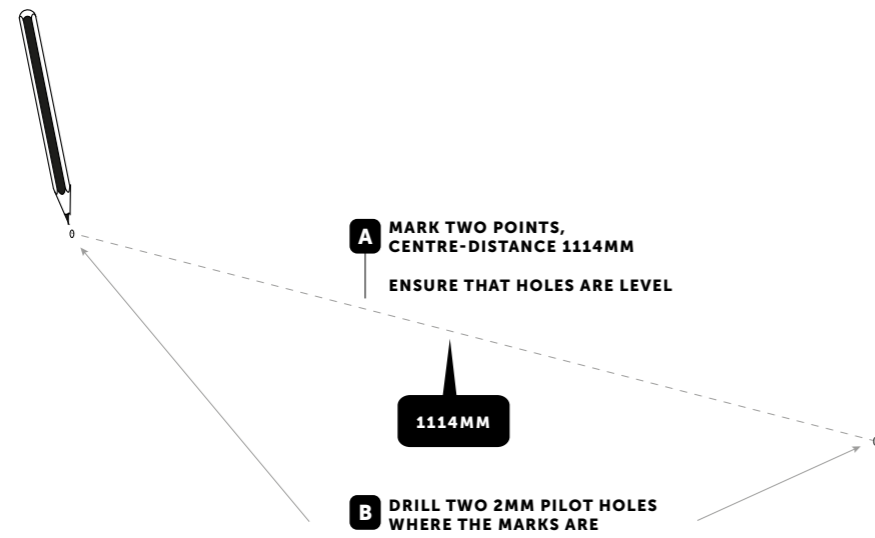

CONSULT THIS DIAGRAM TO DETERMINE THE HEIGHT YOUR SHELF WILL SIT ON THE WALL

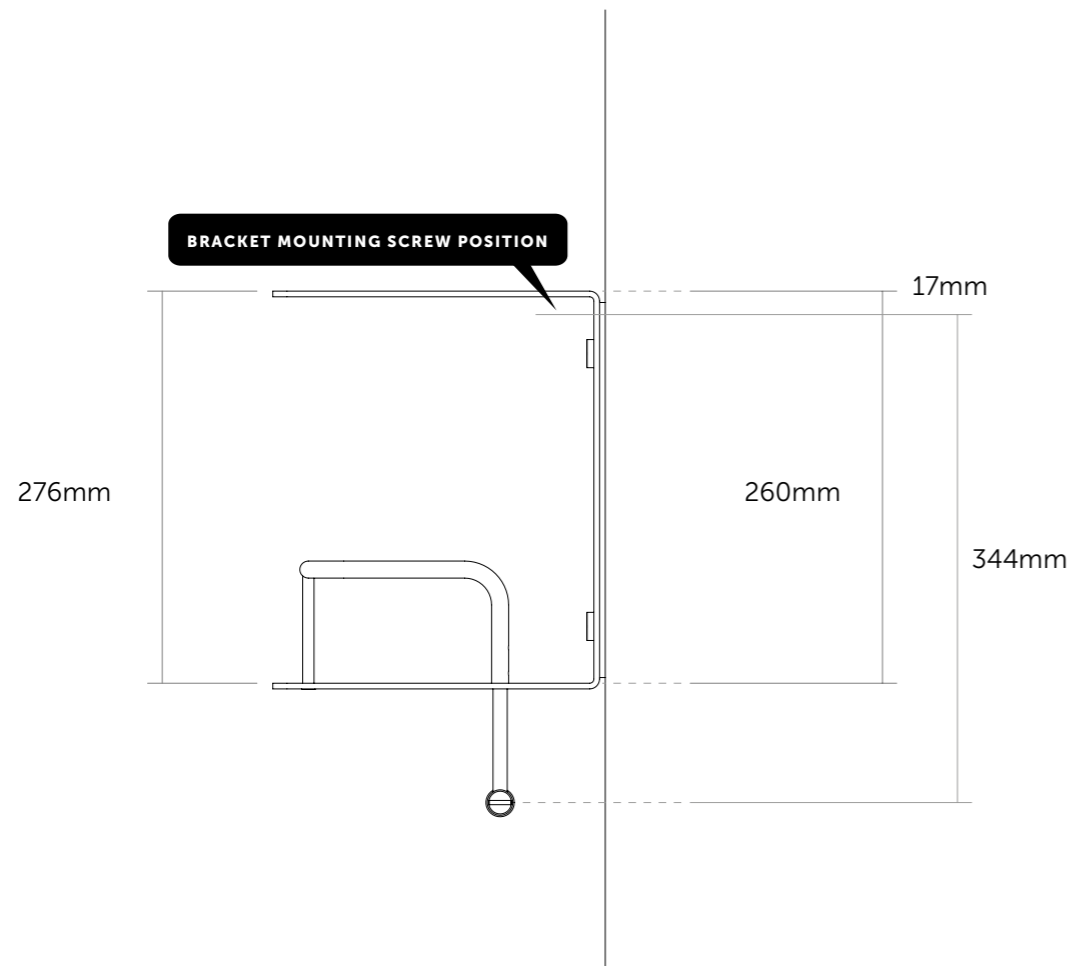

2

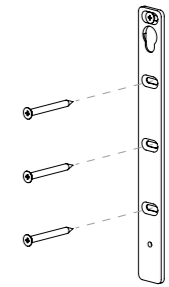
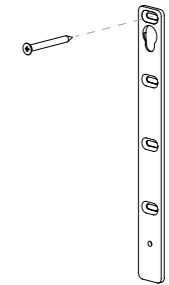
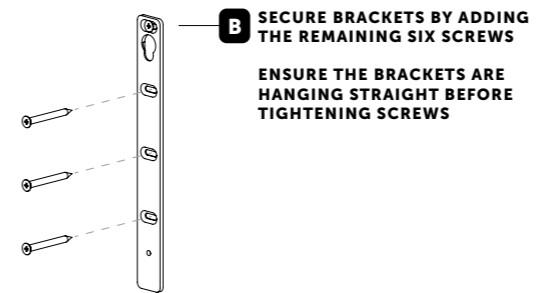
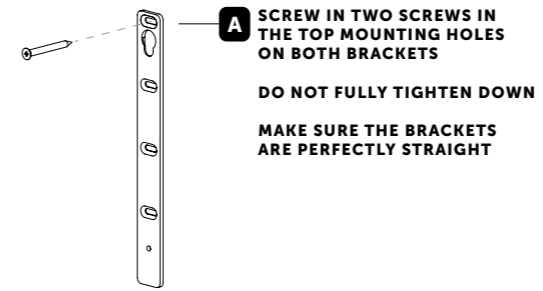
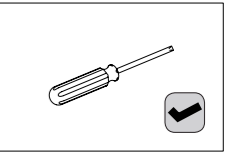

**3** SCREW A COIN CAP AND A COIN CAP MOUNTING COMPONENT TOGETHER, THROUGH THE TOP HOLES (ONE EACH SIDE) IN THE HANGER SHELF BODY

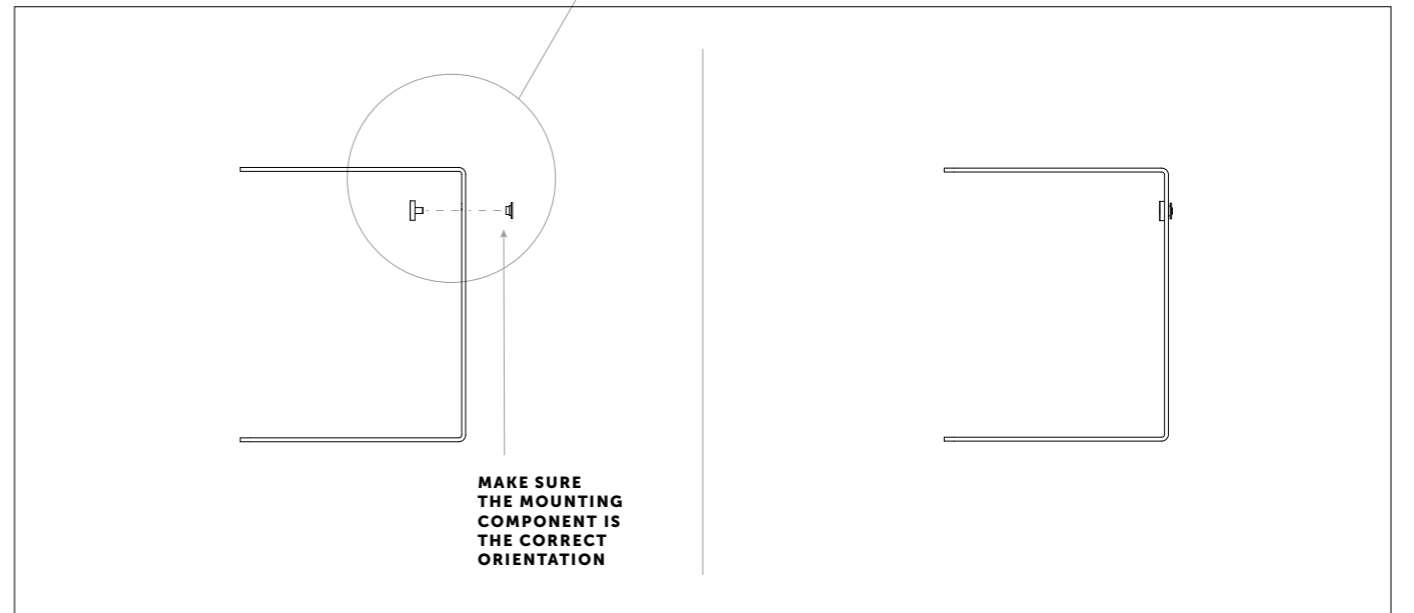
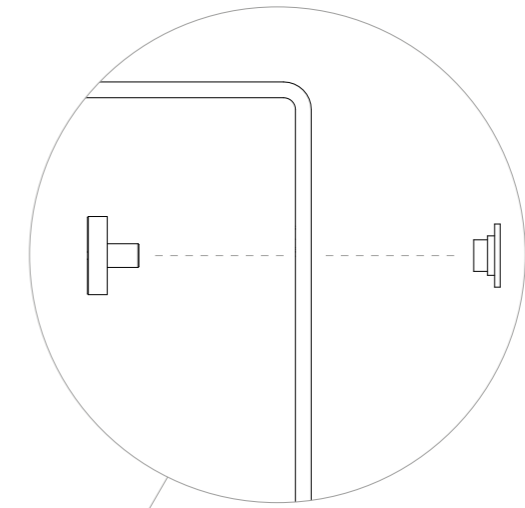
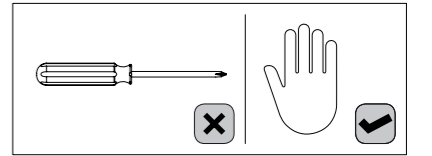
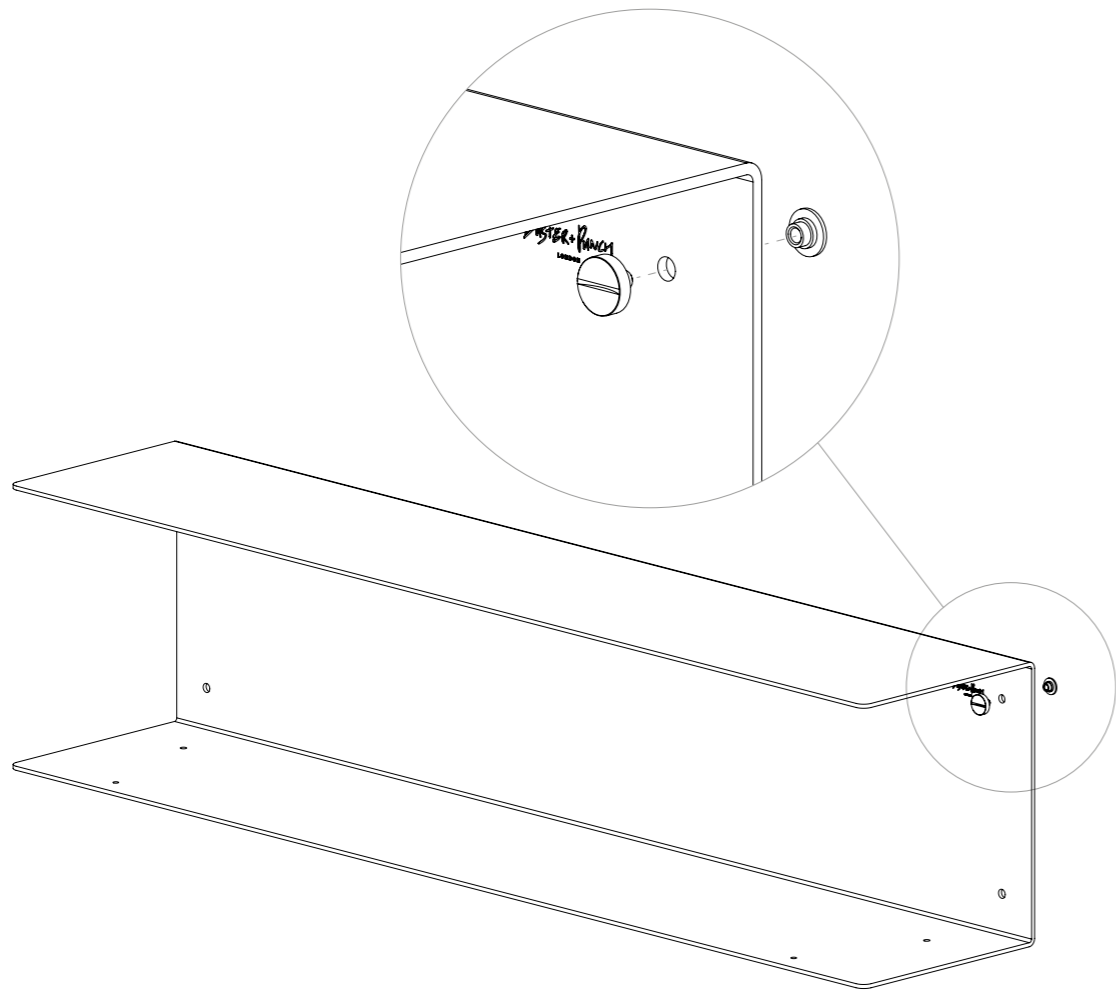

**4**

**HANG THE SHELF ON THE BRACKETS**

**USE THE COIN SCREW CONNECTOR AND  
SLOT THE SHELF INTO THE BRACKETS**

**ONCE THE CONNECTOR IS IN THE HOLE,  
THE SHELF SHOULD DROP DOWN INTO  
THE SLOT ON THE BRACKET**

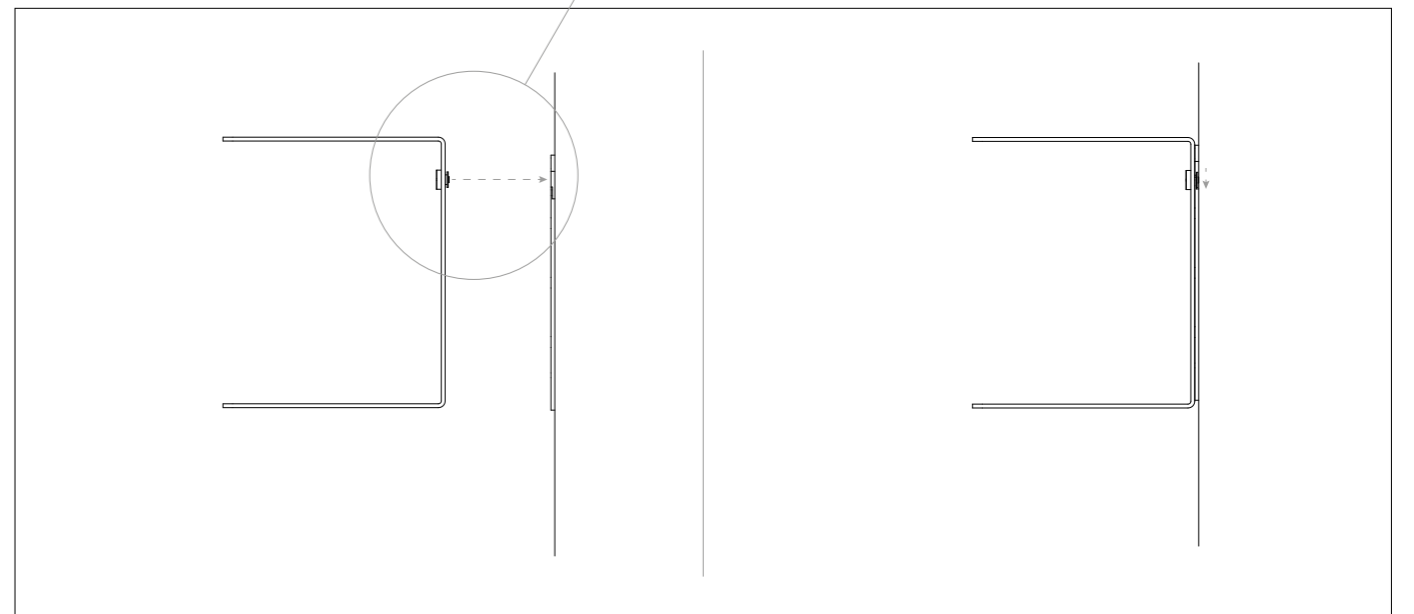
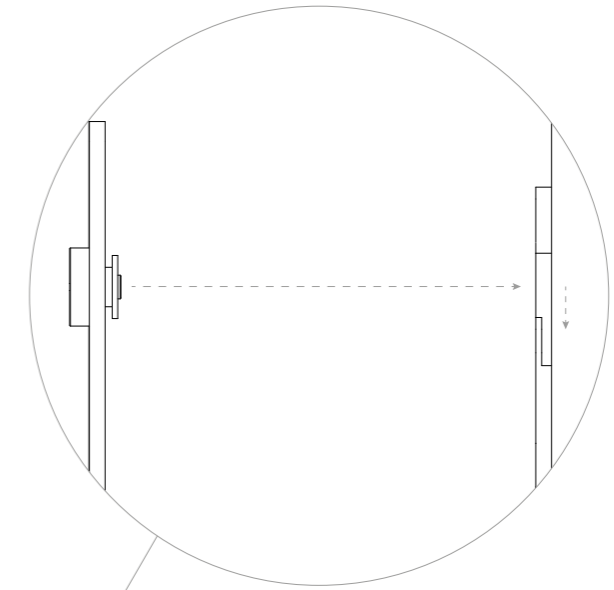
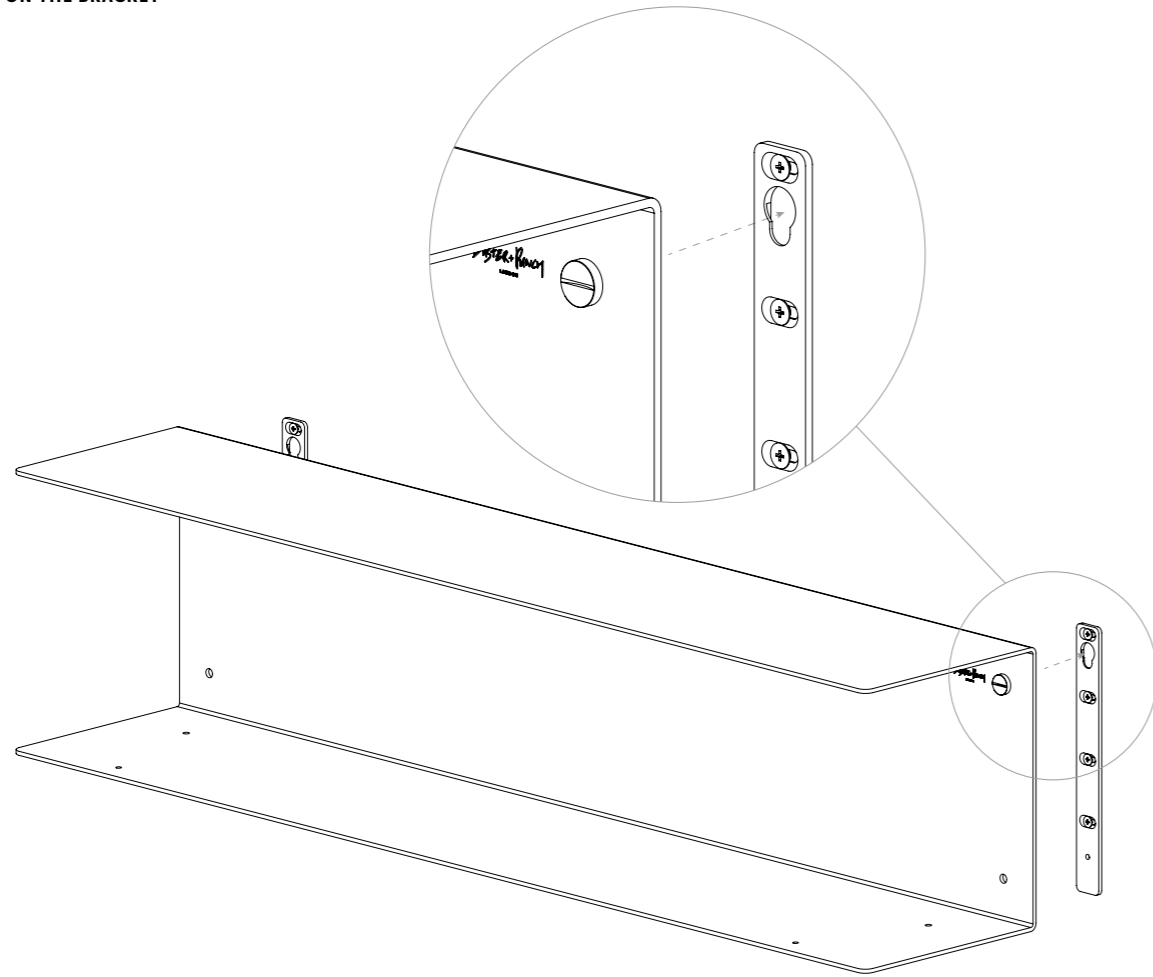
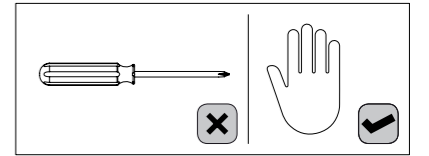

**5**

**SCREW IN THE REMAINING TWO COIN CAPS INTO THE BOTTOM HOLES**

**CHECK ALL FOUR SCREWS TO MAKE SURE THEY ARE ALL TIGHT**

**ENSURE THE SCREWS ARE NOT CROSS-THREADED**

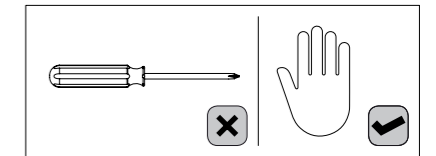
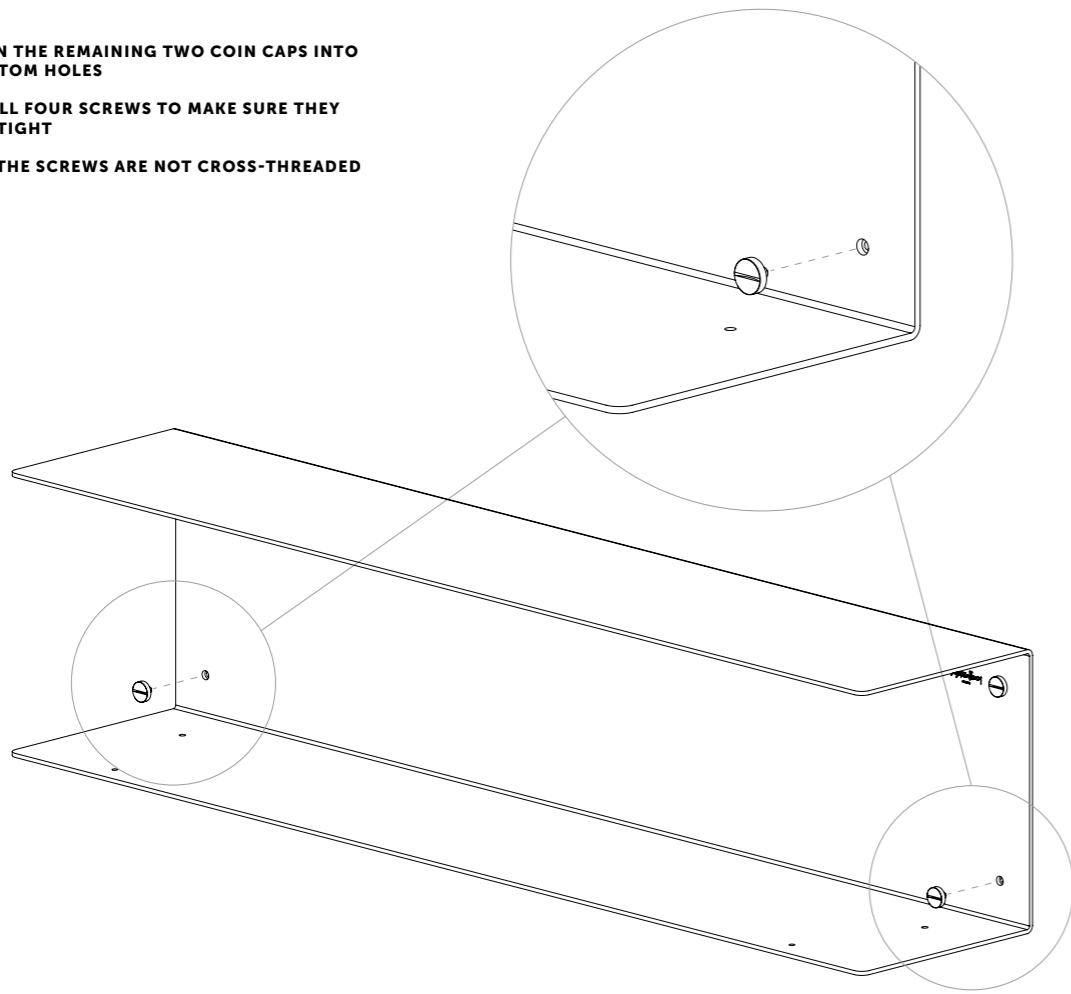

**6**

**ASSEMBLE THE PAN RAIL TO THE SHELF USING THE TWO CONNECTING BOLTS SUPPLIED, THREADING THE BOLTS INTO THE PAN RAIL**

**USE A 3MM ALLEN KEY BOLT TO TIGHTEN THEM**

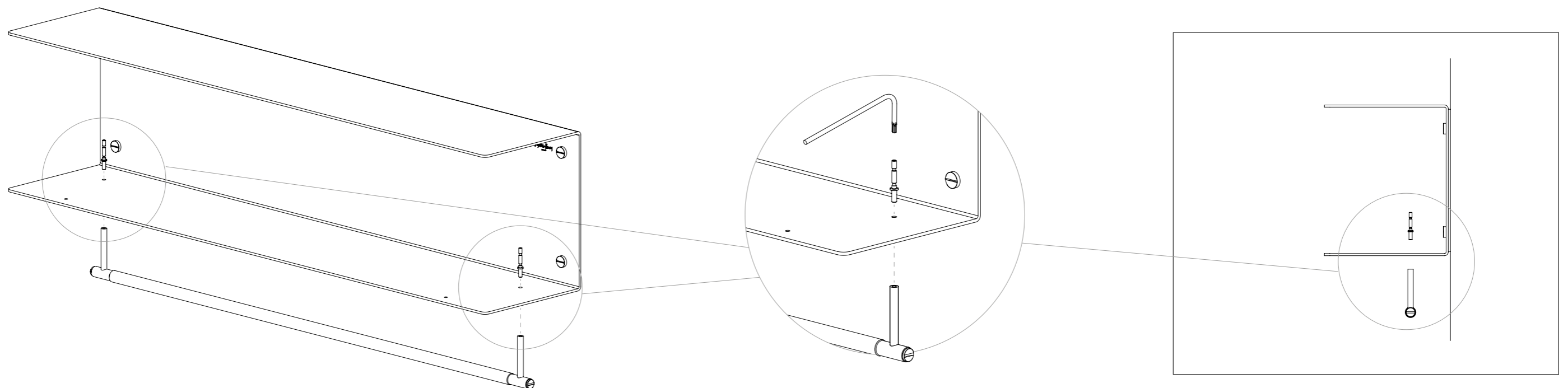

7

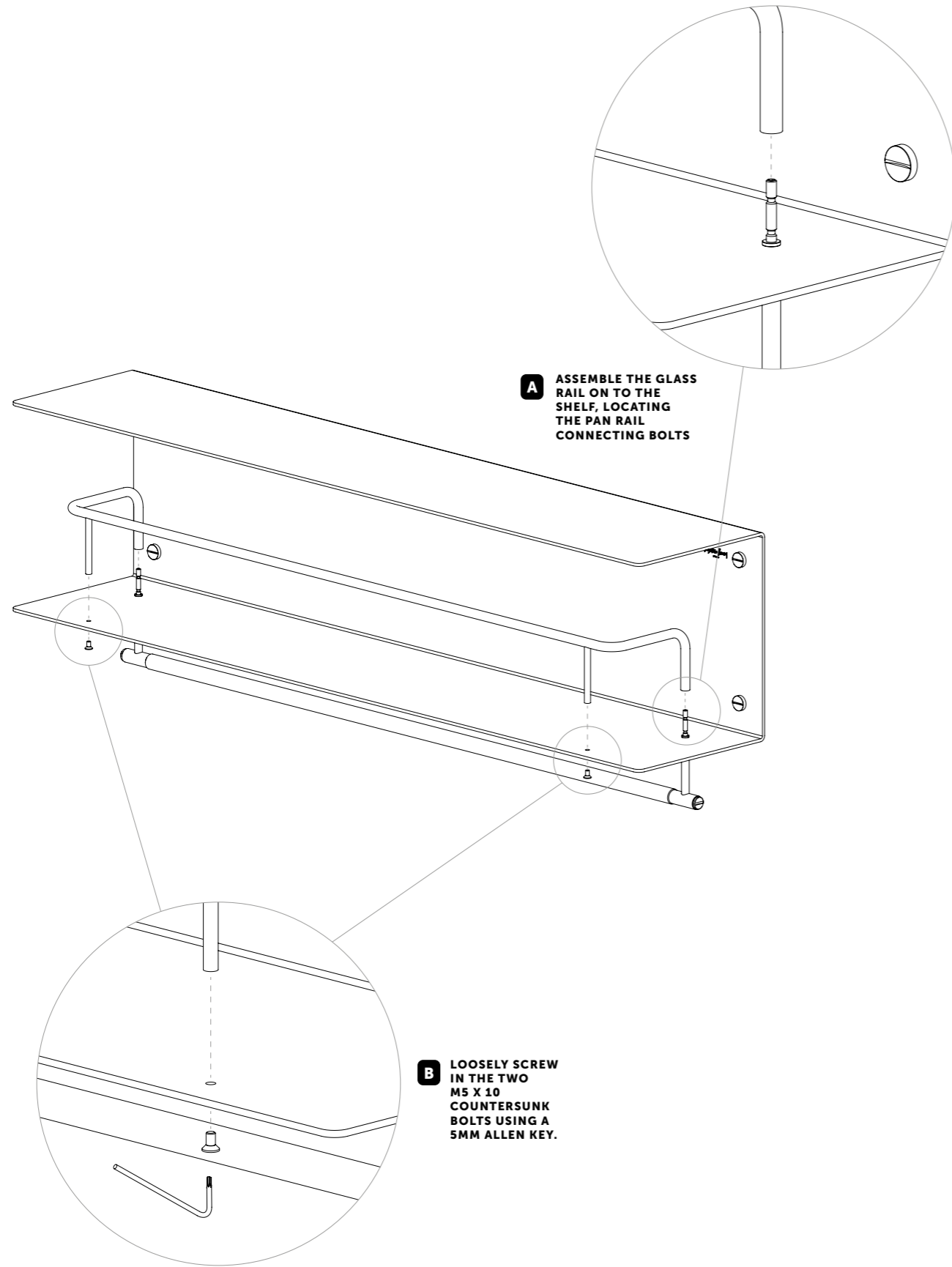

8 SCREW IN THE FOUR GRUB SCREWS TO THE HOLES ON THE BACK OF THE GLASS RAIL, ENSURING THEY ARE TIGHT.

ONCE GRUB SCREWS ARE TIGHT, TIGHTEN THE TWO M5 X 10 COUNTERSUNK BOLTS FOR THE GLASS RAIL ON THE BOTTOM OF THE SHELF

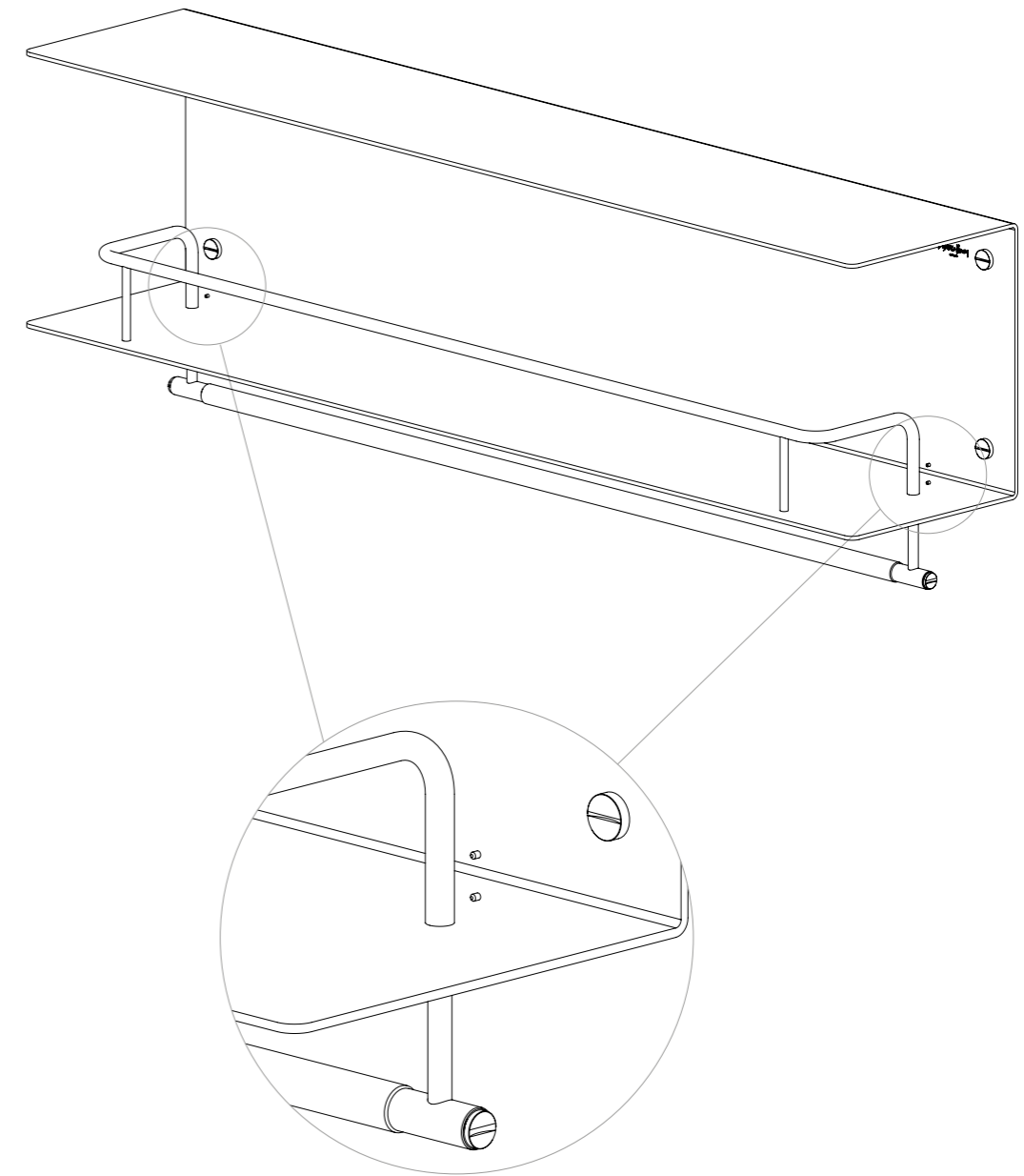

[ end. ORDINARY. ]